

Solitare

Proudly Aussie made

All dimensions in mm

LR515

Round Bowl Topmount Or Undermount Sink With Tap Landing

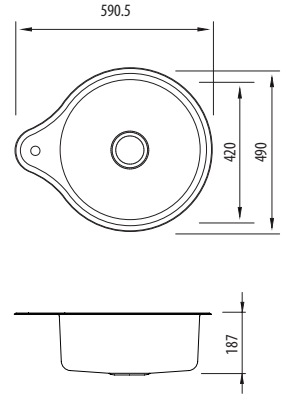

Specifications /

Sink size	590W x 490H mm
Bowl size	Round Bowl 420W x 180D / 24L
Construction	Single piece
Material	304 grade, 18/10 polished stainless steel (0.8 mm thick)
Installation	Topmount recommended
Fixings	Adjustable clips and sealing foam supplied
Min cabinet size	500 mm
Tap holes	1 tap hole only
Waste fittings	1 x 90 mm basket waste included
Overflow	Not available
Carton size	574 x 567 x 230 mm
Weight	4 kg
Warranty	Lifetime manufacturer's warranty (refer to oliveri.com.au)
Maintenance and care instructions	All surfaces should be cleaned with mild liquid detergent or soap and water. To maintain the shine on your Oliveri stainless steel sink, we recommended the use of any of the easy to obtain, non-abrasive stainless steel cleaners or metal polishes.

Included accessories /

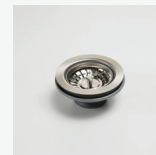

AC14
Basket Waste