



THIS MIXER TAP MUST BE INSTALLED BY A LICENSED PLUMBER IN ACCORDANCE WITH LOCAL REGULATIONS.

This Oliveri tap is manufactured to standard AS/NZS 3718.  
This product complies with the Lead Free requirements of the National Construction Code Volume 3.

MAX OPERATING PRESSURE: ..... 5 bar (500kPa)  
RECOMMENDED OPERATION PRESSURE: ..... 1.5-5 bar (150-500kPa)  
MAX HOT WATER TEMPERATURE: ..... 65°C  
RECOMMENDED HOT WATER TEMPERATURE: ..... 50°C

Where water pressure exceeds 500kPa, a pressure reducing device is required to be installed. Note that water pressure overnight can reach 150% of the daytime pressure.

**Note:** Installation of aerators containing flow regulators: Upon re-installation, the aerator should be tightened with an aerator key to prevent removal by hand.

**Note:** Ceramic Cartridges: Warranty claims will not be honoured where the ceramic cartridge has malfunctioned due to the presence in the water supply of:

- Copper tube pieces, sand, dirt or stones
- Thread tape
- Other objects not normally present in potable water supplies.

Do not remove the cartridge from the body as it has been pressure tested and tightened to a specific torque.

Before attempting any work involving mains water supply lines, ensure the water supply is shut off.

Stop valves (preferably with filters) must be used when installing your Oliveri mixer to allow isolation (not supplied with mixer). Failure to do so where required will void warranty.

This mixer tap is already pre-assembled and tested. Do not disassemble, as this may void the warranty.

This mixer tap must be installed in accordance with these instructions.

**Oliveri Solutions Pty Ltd** ABN 12 007 551 886

51 Naweena Rd, Regency Park SA 5010 P 08 8348 6444 E sales@oliveri.com.au

Issue Date 13/11/2023 Revision Number: V2.0

Verona



## Wall Mixer With Diverter

VA304500CR/VA304516MB/VA304502BN/VA304503CG  
VA304505GM/VA304507WH

### CARE & MAINTENANCE

Clean with a soft cloth and warm soapy water as necessary - rinse and dry after cleaning. Under no circumstances should abrasive or acid based cleaning products be used.

### WARRANTY

PRODUCT	COMPONENT	DOMESTIC USE	COMMERCIAL USE
<b>Bathroom Tapware</b> Excludes Sensor Taps	Cartridge	15 years replacement parts, 1 year labour	7 years replacement parts, 1 year labour
	Body	15 years replacement parts, 1 year labour	5 years replacement parts, 1 year labour
	Finish (chrome) VA304500CR	15 years replacement parts, 1 year labour	1 year replacement parts & labour
	Finish (PVD) VA304502BN VA304505GM	10 years replacement parts, 1 year labour	1 year replacement parts & labour
	Finish (other) VA304516MB VA304503CG VA304507WH	5 years replacement parts, 1 year labour	1 year replacement parts & labour
	Seals, tails, fittings & aerators	5 years replacement parts, 1 year labour	1 year replacement parts & labour

Subject to the terms contained in the full warranty information available at <https://oliveri.com.au/service-and-warranty>, where a genuine manufacturing defect arises within the warranty period Oliveri will, at its election, repair the defect or replace the product.

**This warranty does not cover against normal wear and will be voided if the product is misused or not installed in accordance with these instructions.** Note: Fitting spout-attached devices, including water filters, to this mixer will void warranty.

Our goods come with guarantees that cannot be excluded under the Australian Consumer Law. You are entitled to a replacement or refund for a major failure and for compensation for any other reasonably foreseeable loss or damage. You are also entitled to have the goods repaired or replaced if the goods fail to be of acceptable quality and the failure does not amount to a major failure.

### SERVICE

**If the problem represents a danger, or damage to property may occur, immediately shut off the water supply.** If the mixer tap requires servicing, please contact your plumber (preferably the one who installed it). Most problems occur due to contaminated supply lines or water pressure exceeding 500kPa. Unscrew and clean the spout aerator periodically - especially if you notice a drop in water pressure.

If the Plumber / Installer is satisfied that the problem is not due to poor installation, contact Oliveri's nominated Warranty Service Agent for assistance on:

Ph: (08) 8348 6444 (choose the after sales service & warranty option)

Email: warranty@oliveri.com.au

For full warranty information visit: <https://oliveri.com.au/service-and-warranty>

**If a warranty service call finds that the spout does not have a genuine manufacturing fault, our Warranty Service Agent reserves the right to pass on any call-out fee to the householder.**

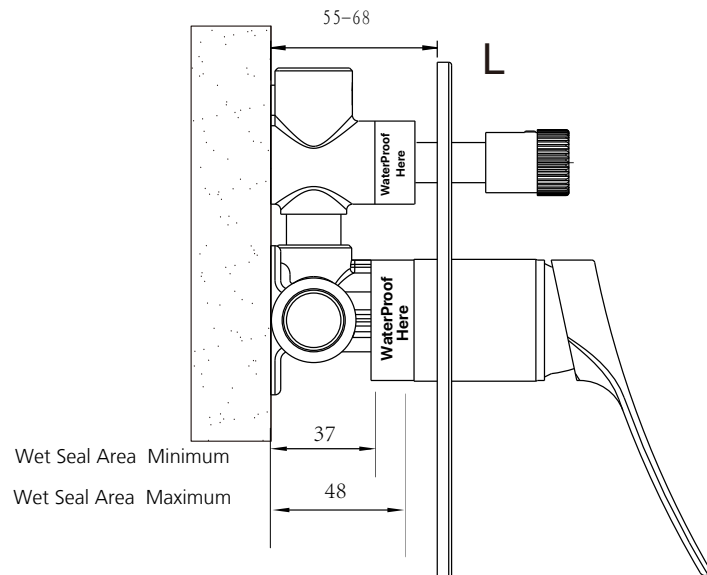
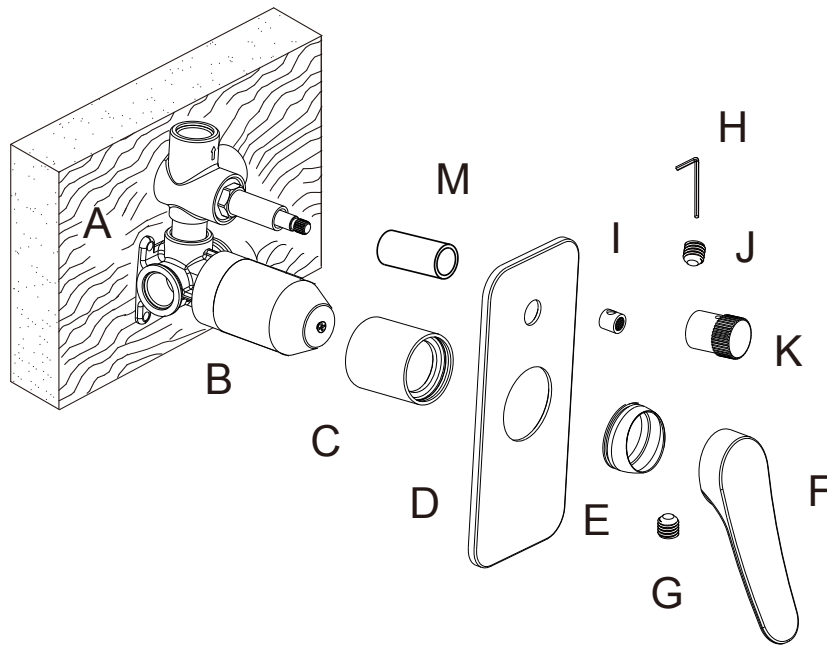

## INSTALLATION INSTRUCTIONS

**General Note:** This product is to be installed by a licenced plumber. Installation must comply with the AS/NZS 3500 series of Standards, Plumbing Code of Australia and applicable plumbing codes and regulations.

### Pressures & Temperatures

Maximum Hydrostatic Pressure: **500kPa**. Note: AS/NZS 3500.1 Subclause 3.3.4 (Maximum pressure within buildings) states "The maximum static pressure at any outlet, other than a fire service outlet, within a building shall not exceed 500kPa. NOTE Pressures above 500kPa can cause damage from water hammer, reduced life of appliances, taps and fittings, and cause excessive noise in the system."

Minimum Hydrostatic Pressure: **150kPa**.

Maximum Temperature: **65°C**. Note: the recommended maximum delivery temperature is 50°C in line with the requirements of NCC Volume 3 Clause B2.5.

**Please ensure that the lines are flushed prior to installation as contaminants in the water can damage the ceramic disc cartridge, flow regulator and affect the performance of the mixer.**

1. Remove product from packaging and check for damages, if the product is damaged do not install and return to store of purchase.
2. Ensure product is complete as per exploded drawing.
3. All Shower and Shower Divertor Mixers are supplied with Plastic Protection Body Covers(B), ensure the Body Cover(B) is on the mixer body, and push pull dial on Divertor Mixers prior to installation.
4. Screw Mixer Body (A) to the Stud Wall or Brick Cavity taking into account set out minimum and maximum from back of Mixer to Finished Wall (L).
5. Install water supply to mixer body, Left (Hot), Right (Cold) as per AS3500 and Local Authority requirements.
6. Install water supply lines for shower and/or bath outlets.
7. Once wall sheeting and tile have been fitted seal around the Mixer Body(A) with plumbers grade silicon or sealing compound. Taking into account set out minimum and maximum from back of Mixer to Finished Wall (L).
8. Remove the Plastic Protective Covers(B).
9. Install Sleeve(C) and (M) to body, **APPLY SOAP OR PLUMBER-GRADE GREASE TO THE O-RING**.
10. Slide Mixer Wall Plate(D) in place. N.B Shower/Bath Wall Plates and Shower & Bath Divertor Wall Plates are fitted with concealed sealing washers, to assist with assembly of the wall plate onto the mixer body apply soapy water or plumbers grade grease to the concealed sealing washers.
11. Put the Decorative Cover (E) into the Sleeve (C), pay attention to the highest point down, so as not to scratch the Handle (F).
12. Fit Mixer Handle (F).
13. Screw in Handle Grub Screw (G) by using Allen key (H).
14. Adjust the divertor mixers to the right position, put on Plastic Adaptor (I) then put on Handle (K), make sure hole in the handle aligns with the hole in the plastic.
15. Screw in Handle Grub Screw (J) by using Allen key (H).

### TO THE CONSUMER

1. The mixer is to only be cleaned with warm soapy water and a soft cloth.
2. Under no circumstances should any abrasive, cream or acid based cleaning agents be used as these types of cleaners will damage the finish, cartridge, seals and aerators.