

Puro

PU2855

Single Bowl Topmount Care Sink

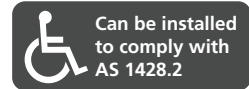

All dimensions in mm

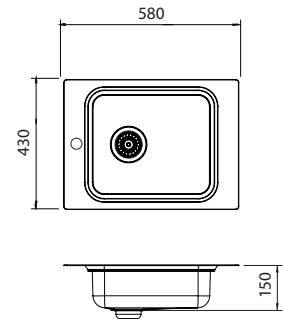

REVERSIBLE SINK

Your installer will install depending on which side you require your sink's waste outlet/tap.

Also available with no taphole (PU2850)

Specifications /

| | |
|--|--|
| Sink size | 580W x 430H x 150D mm |
| Bowl size | Main Bowl 330W x 390H x 135D / 14 L |
| Construction | 2 piece, bowls and drainer seam welded |
| Material | 304 grade, 18/10 polished stainless steel (0.9 mm thick) |
| Heat protection | Supplied with insulation pad to bottom of bowl |
| Installation | Topmount recommended |
| Fixings | Adjustable clips and sealing foam supplied |
| Min cabinet size | 500 mm |
| Tap holes | Available with 0 (PU2850) or 1 tap hole (PU2855) |
| Waste fittings | 1 x 90 mm basket waste included |
| Overflow | Not available |
| Carton size | 666 x 518 x 230 mm |
| Weight | 4.0 kg |
| Warranty | Lifetime manufacturer's warranty (refer to oliveri.com.au) |
| Maintenance and care instructions | All surfaces should be cleaned with mild liquid detergent or soap and water. To maintain the shine on your Oliveri stainless steel sink, we recommended the use of any of the easy to obtain, non-abrasive stainless steel cleaners or metal polishes. |

Included accessories /

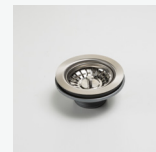

AC14
Basket Waste